

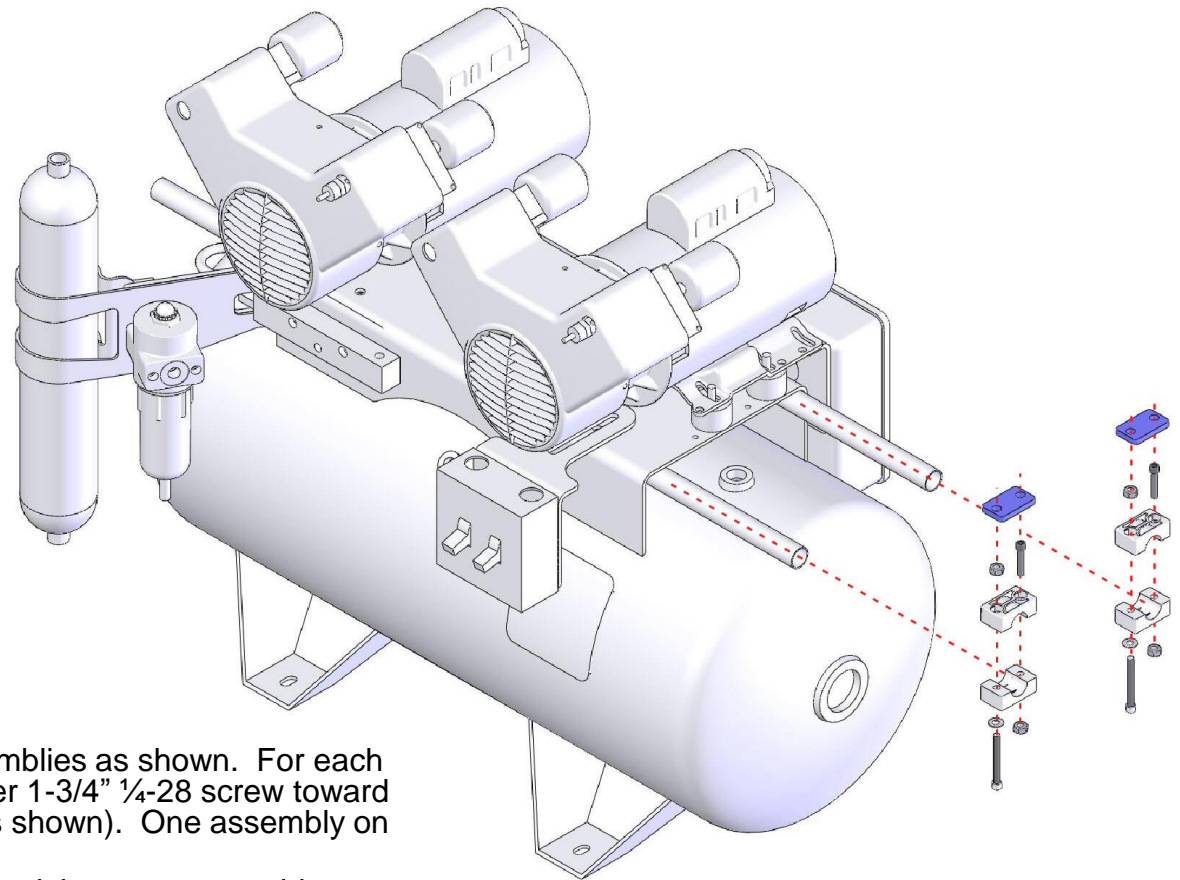

## Compressor Sound Cover Installation Instructions, Two or Three Head



1. Assemble 4X pipe clamp assemblies as shown. For each pair of screws, place the longer 1-3/4" 1/4-28 screw toward the front of the compressor (as shown). One assembly on either end of each handle.
2. Tighten down long screw first and then turn assembly so that long screw is pointing up (as shown).
3. Before tightening down shorter screws from the top, place base of sound cover over the four long screws. Align base/clamps to ensure base is centered on the compressor.
4. Remove base plate and tighten all four shorter screws.

## Compressor Sound Cover Installation Instructions, Two or Three Head

1. Snap remote air intake in place as shown. Fit should be snug. Ensure fittings are pointing forward after snapping into place.
2. Place base plate\* over screws again and secure using 4 locking wingnuts.

\* Foam has been removed for clarity.

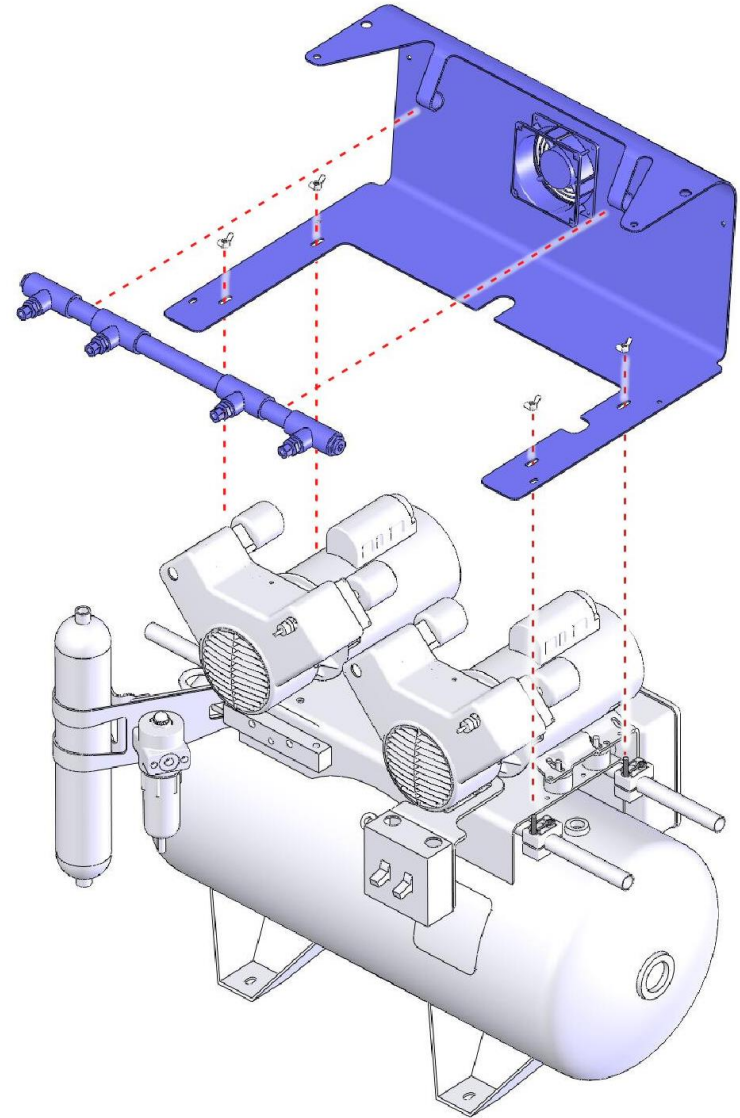

## Compressor Sound Cover Installation Instructions, Two or Three Head

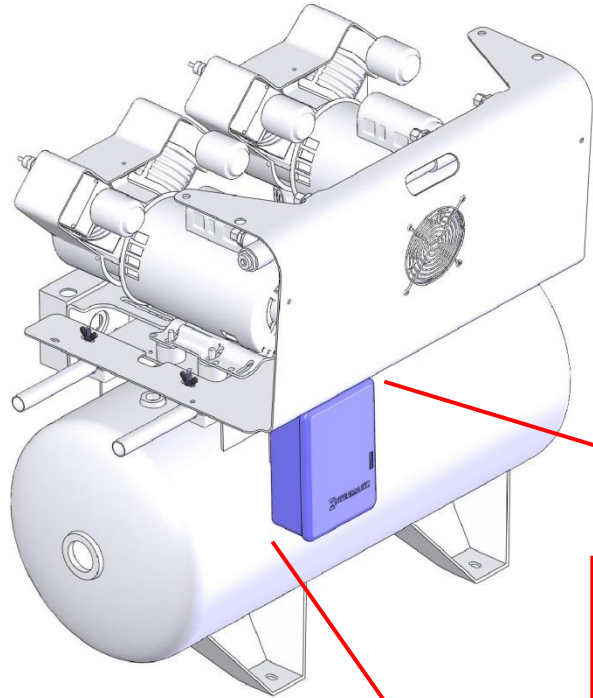

- For a three head compressor, splice two pigtail fan wires together in parallel.
- Install and crimp flag terminals to end of pigtail wires for fan (see picture below).
- Plug flag terminals into low voltage control box as shown.
- Connect plug on end of pigtail wire to axial fan.

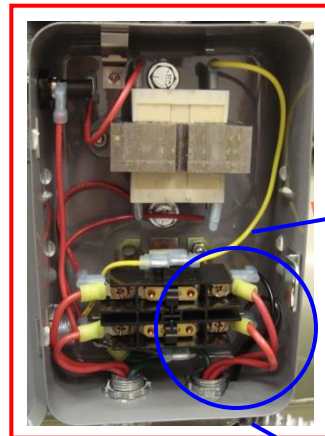

**2 - Head**



**3 - Head**

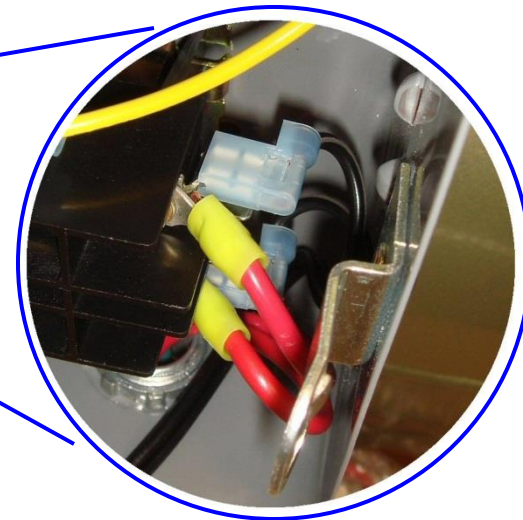
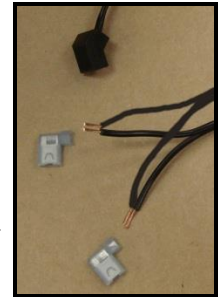

## Compressor Sound Cover Installation Instructions, Two or Three Head

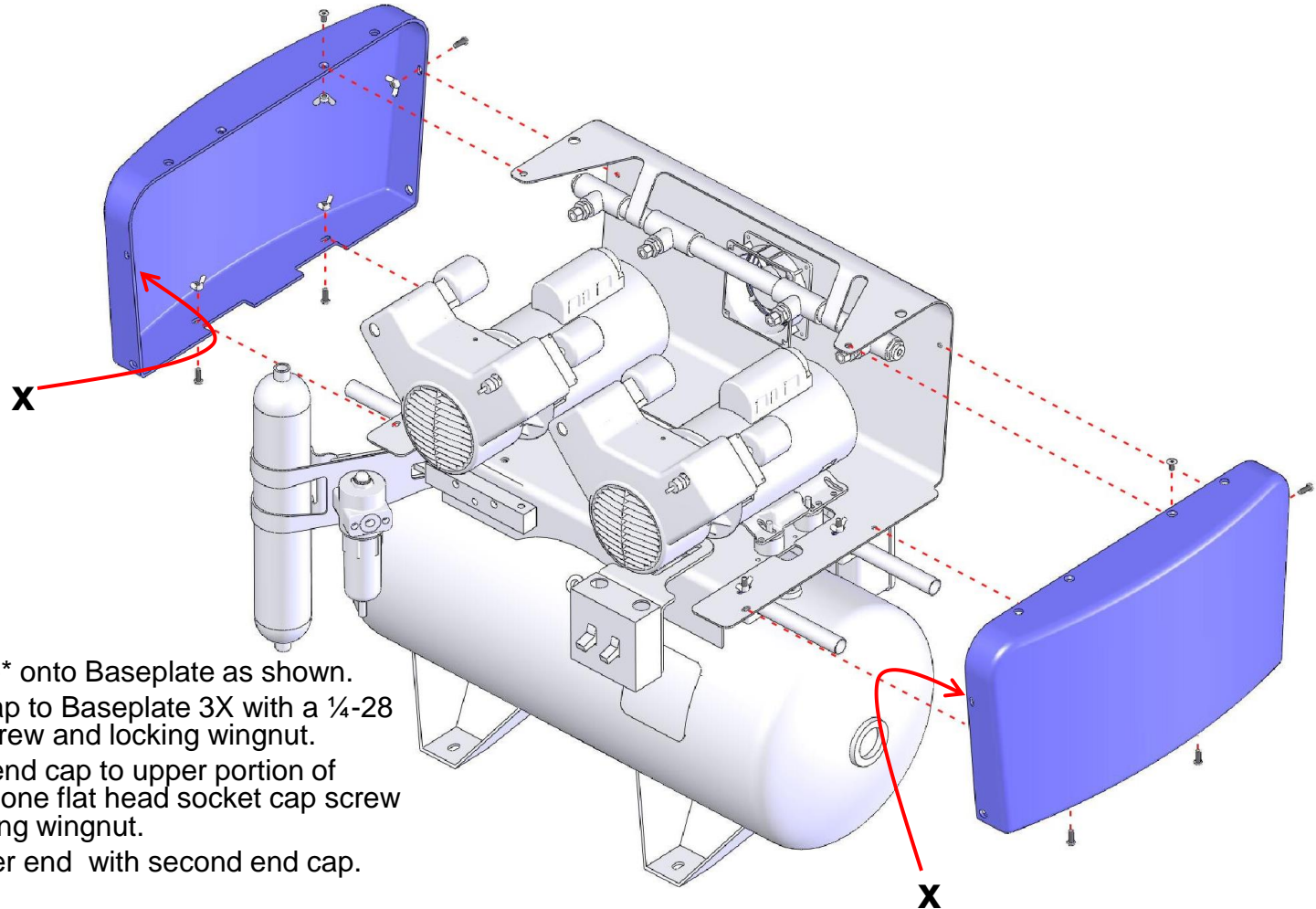

1. Place End Cap\* onto Baseplate as shown.
2. Secure End Cap to Baseplate 3X with a ¼-28 button head screw and locking wingnut.
3. Secure top of end cap to upper portion of baseplate with one flat head socket cap screw ¼-28 and locking wingnut.
4. Repeat on other end with second end cap.

\* Foam has been removed for clarity.  
End cap has an extra foam piece installed. The end caps should be placed such that this extra piece is along the inside front edge (x).

## Compressor Sound Cover Installation Instructions, Two or Three Head

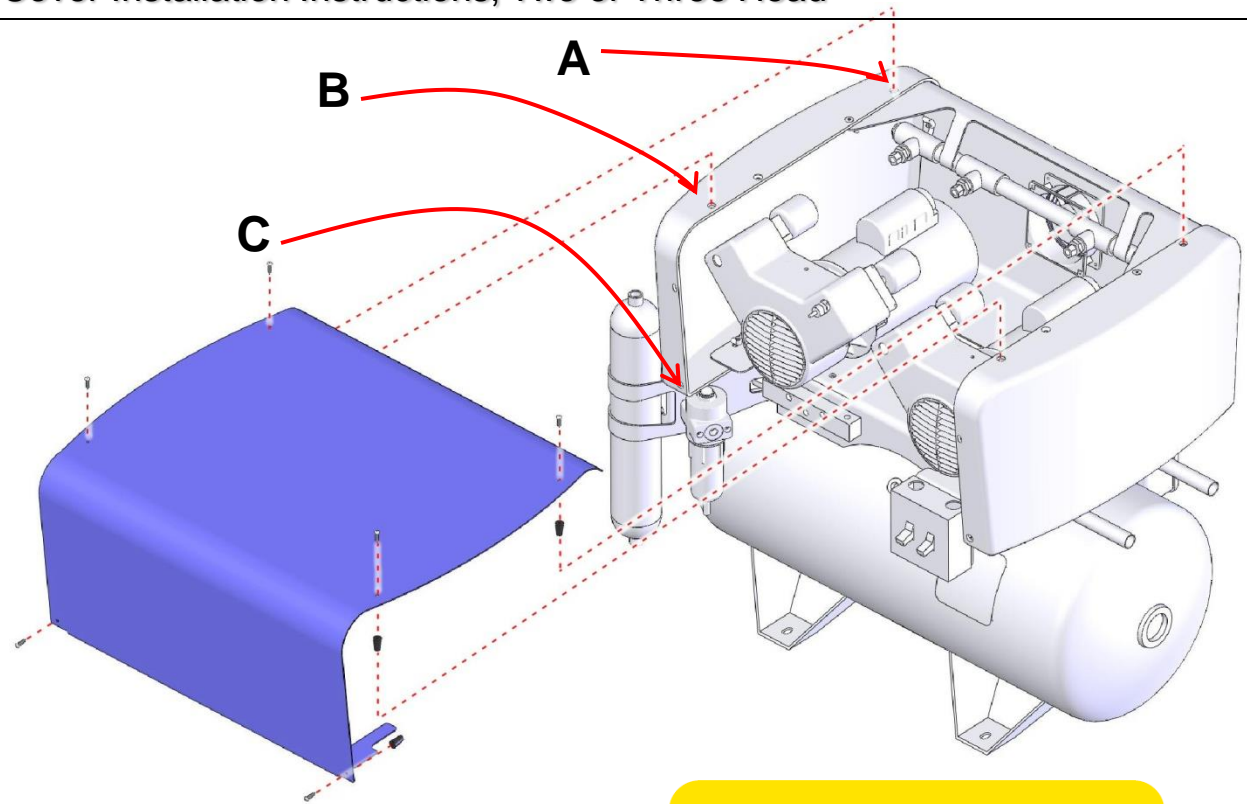

1. Install 6X one screw and one rubber bayonet pin as shown.
2. Using the yellow cover removal sticker as a guide, install the cover in reverse order as shown.
3. Place rubber bayonets in positions (A), then (B) and finally (C).

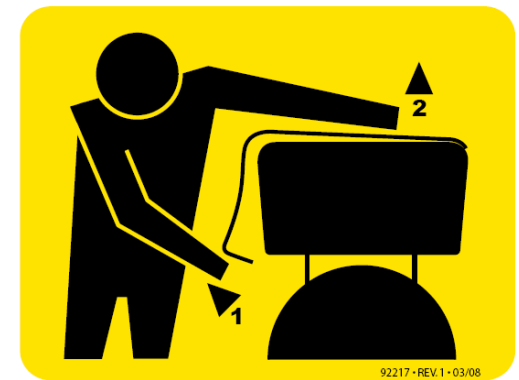

**cover removal sticker**